

ITEM #	DESCRIPTION	QTY.
1	BACK PLATE	1
2	LEFT SIDE PANEL	1
3	RIGHT SIDE PANEL	1
4	FRONT PANEL	1
5	COVER	1
6	VENT TRAY	1
7	RECTANGULAR PLATE	6

4U FOR EQUIPMENT MOUNTED  
VERTICALLY ON BACKPLATE

2U FOR EQUIPMENT MOUNTED  
VERTICALLY INSIDE OF BACKPLATE

8U FOR EQUIPMENT MOUNTED  
VERTICALLY ON SIDE PANELS

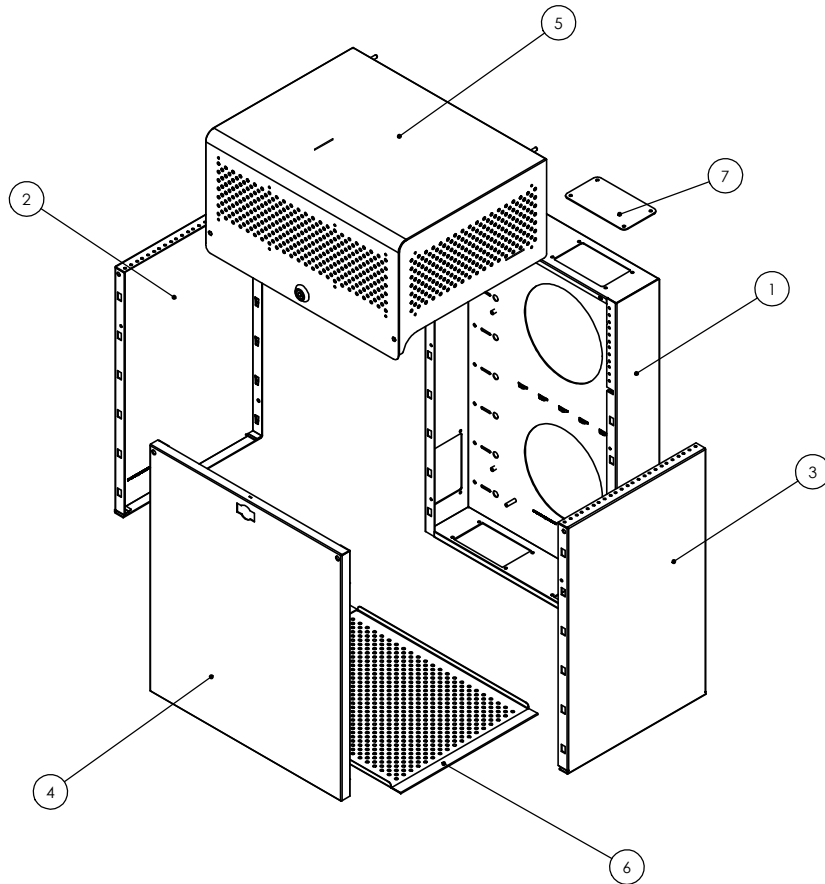
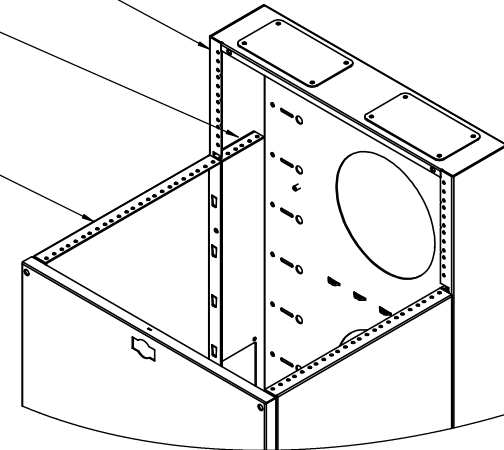

#### NOTES:

1. INSTALLATION MUST COMPLY WITH NATIONAL AND LOCAL ELECTRICAL REGULATIONS.
2. ALL DIMENSIONS ARE IN INCHES.
3. NET WEIGHT OF UNIT IS 60 LBS.
4. CABLE ENTRY IS TOP, BOTTOM, AND SIDES OF UNIT.
5. EQUIPMENT MOUNTING IS 12-24 TAPPED IN EIA PATTERN.
6. CAPACITY IS 400 LBS. WHEN MOUNTED AS RECOMMENDED.
7. CONSTRUCTION IS 14AWG C.R. STEEL WITH BLACK POWDER COAT FINISH.



**PROPRIETARY AND CONFIDENTIAL**  
THE INFORMATION CONTAINED IN THIS  
DRAWING IS THE SOLE PROPERTY OF  
BLACKHAWKLABS. ANY REPRODUCTION  
IN PART OR AS A WHOLE WITHOUT  
THE WRITTEN PERMISSION OF  
BLACKHAWKLABS IS PROHIBITED.

COMMENTS:

MRQ350S14  
Sheet 1/2

TITLE:

MiniRaQ Standard

SIZE

C

DWG. NO.

90-071

DATE

3-6-11

DRAWN BY

ML

REV

2

SCALE: 2:1

WEIGHT: 60 lbs

SHEET 1 OF 2

TOP

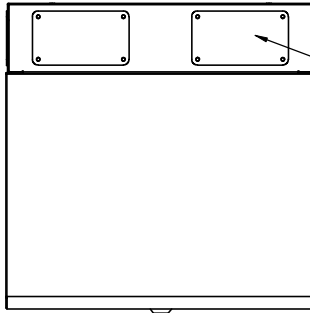

TWO PLATES COVERING  
3"x5" CABLE ACCESS OR  
ACCESSORY HOLES

FRONT

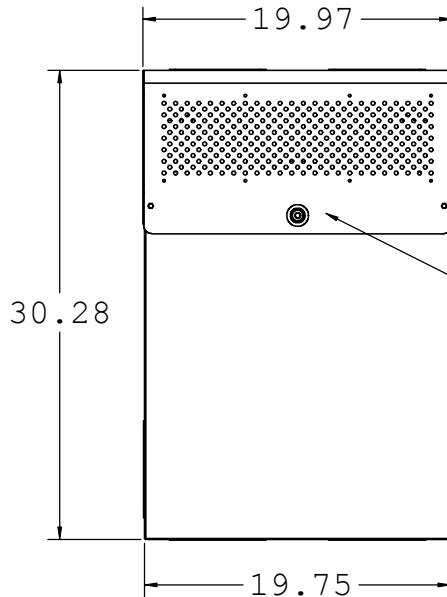

DOUBLE  
CAM LOCK

BOTTOM

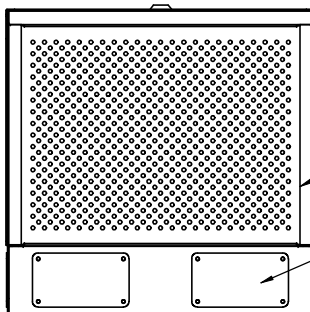

LOWER VENT TRAY

TWO PLATES COVERING  
3"x5" CABLE ACCESS OR  
ACCESSORY HOLES

RIGHT

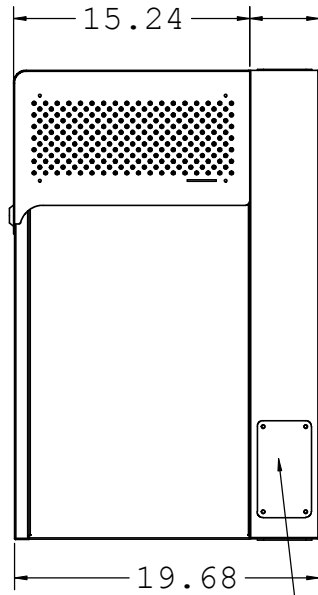

ONE PLATE EACH  
SIDE COVERING 3"x5"  
CABLE ACCESS OR  
ACCESSORY HOLES

10 RAISED BRIDGE  
LANCES FOR CABLE  
MANAGEMENT (INTERNAL)

REAR

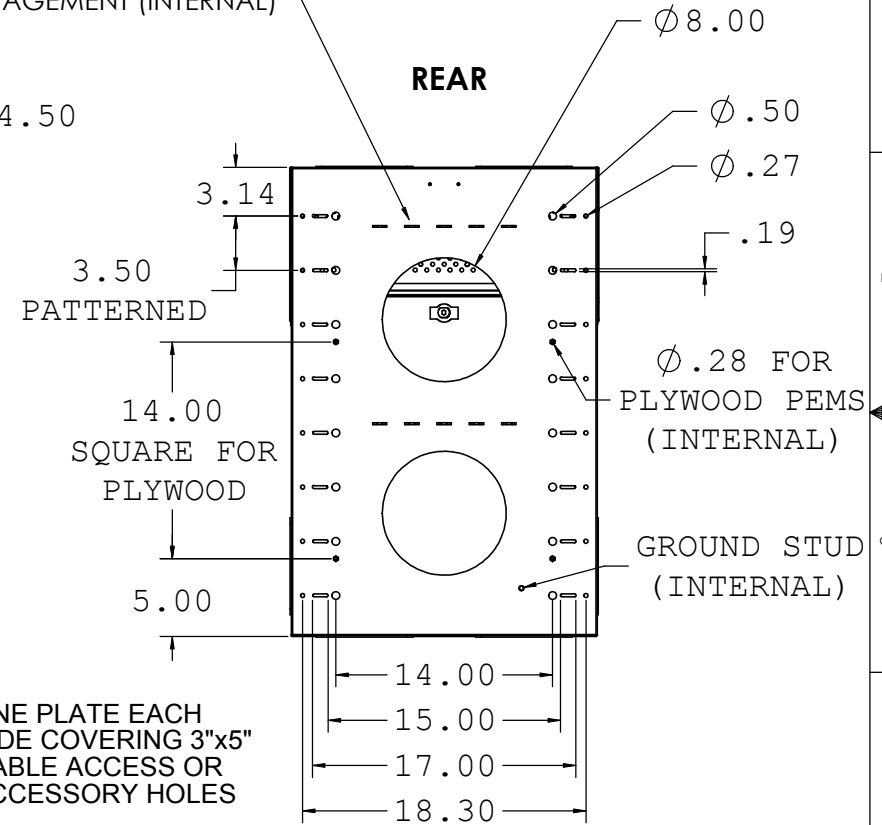

Ø 8.00

Ø .50

Ø .27

.19

Ø .28 FOR  
PLYWOOD PEMS  
(INTERNAL)

GROUND STUD  
(INTERNAL)

**NOTES:**

1. INSTALLATION MUST COMPLY WITH NATIONAL AND LOCAL ELECTRICAL REGULATIONS.
2. ALL DIMENSIONS ARE IN INCHES.



PROPRIETARY AND CONFIDENTIAL  
THE INFORMATION CONTAINED IN THIS  
DRAWING IS THE SOLE PROPERTY OF  
BLACKHAWKLABS. ANY REPRODUCTION  
IN PART OR AS A WHOLE WITHOUT  
THE WRITTEN PERMISSION OF  
BLACKHAWKLABS IS PROHIBITED.

COMMENTS:

MRQ350S14  
Sheet 2/2

TITLE:

MiniRaQ Standard

SIZE

C

DWG. NO.

90-071

DATE

3-6-11

DRAWN BY

ML

REV

2

SCALE: 2:1

WEIGHT: 60 lbs

SHEET 2 OF 2