

Great Lakes



Great Lakes Case & Cabinet Co., Inc.

1984-KM KEYBOARD AND MOUSE SHELF



www.WeRackYourWorld.com

product spotlight

*A shelf made for two!
Togetherness is nice.*

Your flat screen monitor is mounted in a convenient two (or maybe four) post rack. What about the keyboard and mouse?

Great Lakes Case & Cabinet Co., Inc. has a shelf just for you. The 1984-KM is ergonomically designed to specifically mount to Great Lakes' series of 19" racks. The shelf holds a standard keyboard, with a swivel platform (with mouse pad) which can be easily mounted for left or right hand users.

As is the case for all Great Lakes' rack mount accessories, the 1984-KM can be mounted at any height for comfortable use. Working with your computer has never been easier on a Great Lakes rack!

For more information on this or other products offered by Great Lakes Case & Cabinet Co., Inc., visit us on-line or call 1-866-Try-GLCC (1-866-879-4522).

Part No.	Description
1984-KM	Keyboard and Mouse Shelf



Great Lakes Case & Cabinet Co., Inc.

1984-KM Keyboard and Mouse Shelf

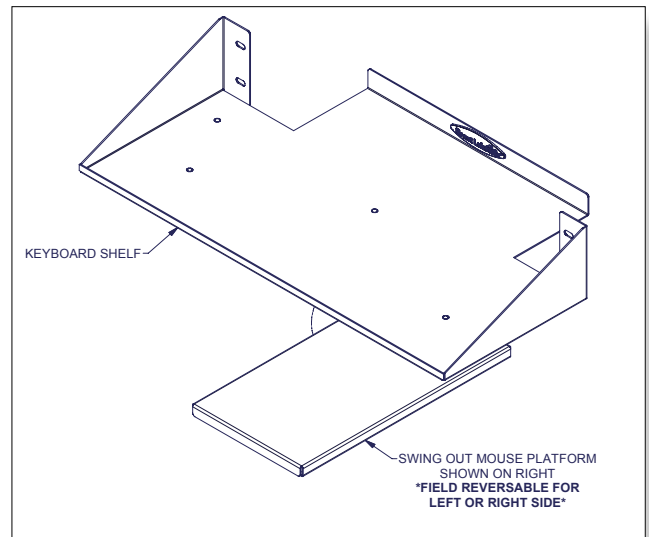
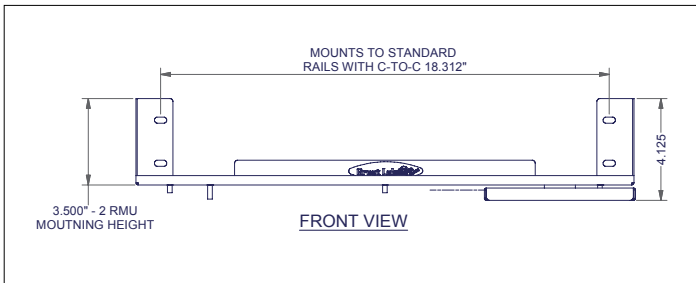
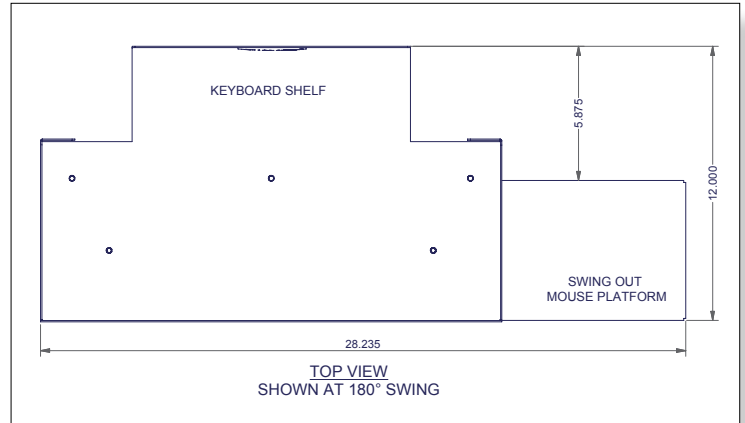
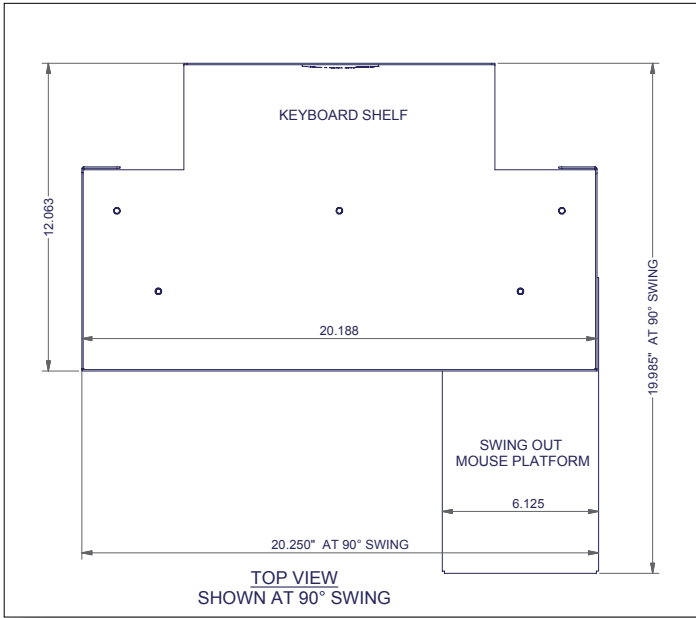

For more information, or to order, call
1-866-TRY-GLCC.

*weRack
your
World!*

Corporate Headquarters

P.O. Box 551 • Edinboro, PA 16412 • 1-866-TRY-GLCC • (1-866-879-4522) • Phone: 814.734.7303 • Fax: 814.734.3907 • glcc@greatcabinets.com

Western Distribution • 535 East Glendale Avenue • Sparks, NV 89431 • Phone: 775.829.9913 • Fax: 775.829.9926

Great Lakes International • Aerbridge House • Dunshaughlin Business Park • Dunshaughlin Co. Meath • Ireland • Phone: 003531 8258777 • Fax: 003531 8258778