

INSTALLATION INSTRUCTIONS FOR OHM

Install data jacks as described in the installation instructions provided with the data adapters, BE01421

Ohm		"X" Dim.
BE02684-H	2 ports	5.00
BE02684-H	3 ports	6.50
BE02684-H	4 ports	8.00
BE02684-H	5 ports	9.50
BE02684-H	6 ports	11.00
BE02684-H	7 ports	12.50
BE02684-H	8 ports	14.00

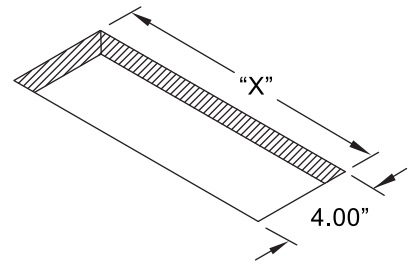

Note: When managing conduit and cabling exiting the unit, ensure there is adequate slack to allow unit to open properly.

Attach 2 clips, one at each end on back of unit base.

Note: Metal clips are for use in hard surface material only as an optional mounting means.

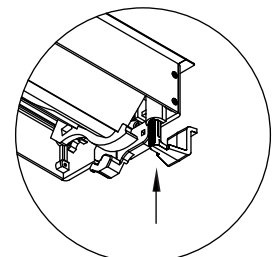
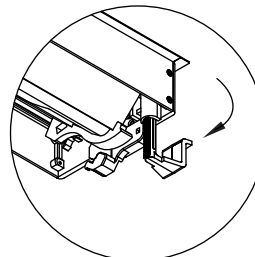
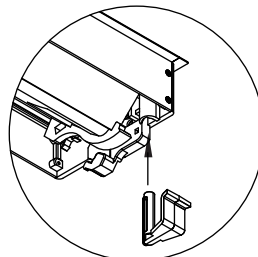
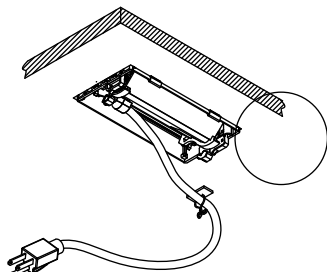
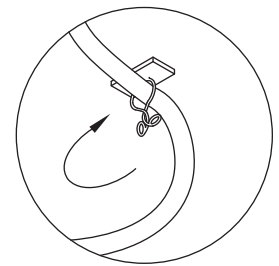
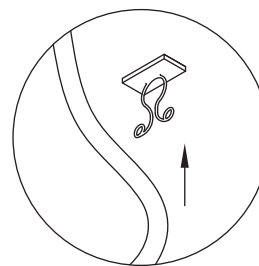
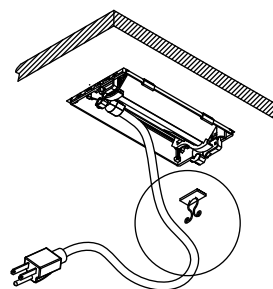
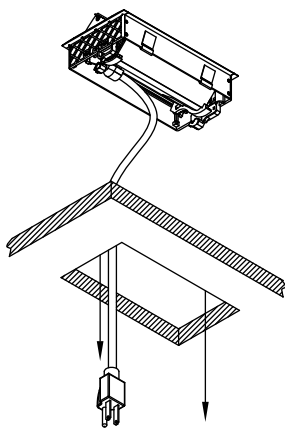
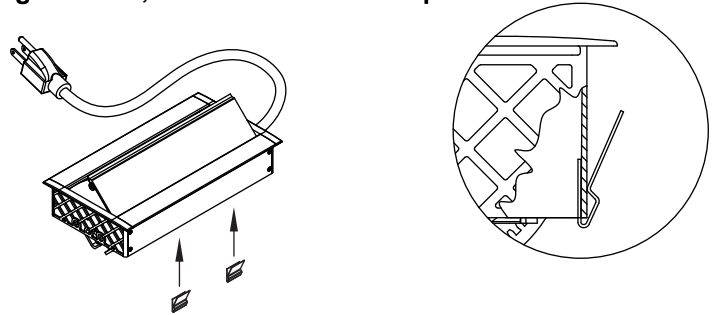

Note: In a conduit application; conduit should be supported according to local code.