

THIS COPY IS PROVIDED ON A RESTRICTED BASIS AND IS NOT TO BE USED IN ANY WAY DETRIMENTAL TO THE INTERESTS OF PANDUIT CORP.

PANDUIT P/N	WEIGHT
C6PPLK1-24	.11 LB/10 PCS (51.4 g/10 PCS)

NOTES:

- SEE CURRENT CATALOG FOR ADDITIONAL PART NUMBER SUFFIXES TO INDICATE COLOR AND OR PACKAGE QUANTITY.
- SEE CATALOG FOR COMPLETE LIST OF PARTS APPLICABLE FOR USE WITH THIS PART.
- DIMENSIONS IN PARENTHESES ARE IN METRIC.
- MATERIAL:  
LABEL- VINYL  
(BACK SIDE OF LABEL IS BLANK)  
LABEL COVER- PETG
- PART INCLUDES:  
1- LABEL SET (INCLUDES 4 LABELS)  
4- LABEL COVER

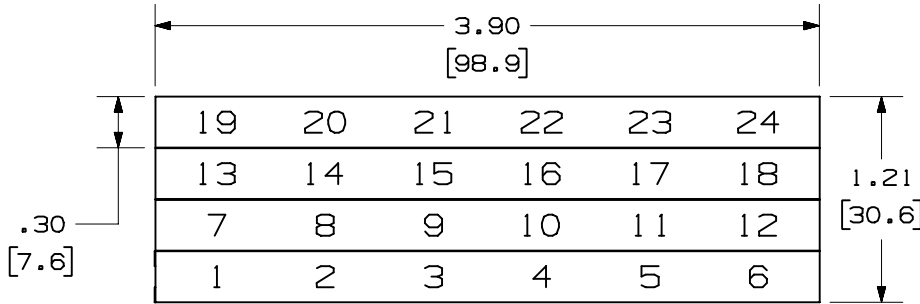

LABEL SET

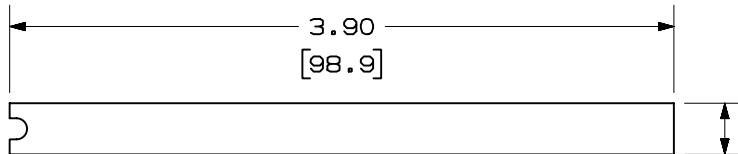

LABEL COVER

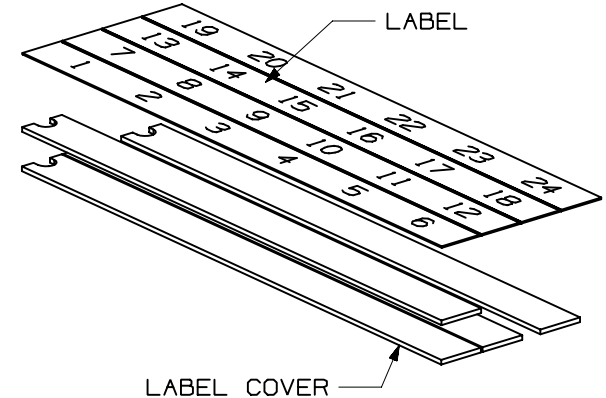

CAD FILENAME/LAYERS M00742E0\_DC\_00A.PRT

**PANDUIT** CORP. TINLEY PARK, ILLINOIS  
(1-24) 6 POSITION FACEPLATE  
PATCH PANEL LABEL KIT  
(C6PPLK1-24) CUSTOMER DRAWING

UNLESS OTHERWISE SPECIFIED,  
DIMENSIONAL TOLERANCES ARE:

(.X) ±.03(.7)(.XXX) ±  
(.XX) ±.01(.2) ANGLES ± 1°

UNLESS OTHERWISE SPECIFIED,

ALL DIMENSIONS ARE GIVEN  
IN INCHES, THIRD ANGLE PROJECTION.

DRAWN BY  
JsP

MAT'L:

SCALE FULL

REV	DATE	BY	CHK	DESCRIPTION	ECN - R	CUST	SUP	OTH
R	7-30-01	JsP		RELEASED TO PRODUCTION	00742-88			

DATE  
7-30-01

DRAWING NO.

00742-88

DWG  
A  
SIZE