



PANDUIT PART NUMBER	WEIGHT
FR6TB12 FR6TB12M	1.23 LB/EACH (559g/EACH)



NOTES:

- SEE CURRENT CATALOG FOR ADDITIONAL PART SUFFIXES TO INDICATE PACKAGE QUANTITY.
- THE FIBERRUNNER 4x4 AND 6x4 QUIKLOCK TRAPEZE BRACKET IS USED TO SUPPORT THE FIBERRUNNER 4x4 AND/OR 6x4 CABLE ROUTING SYSTEMS BETWEEN TWO (2) SECTIONS OF NEW OR EXISTING 1/2" (M12) THREADED ROD THAT ARE 10" (254) - 13" (330.2) APART.
- THE FIBERRUNNER 4x4 AND 6x4 QUIKLOCK TRAPEZE BRACKET INCLUDES:
ONE (1) BRACKET ASSEMBLY,
FOUR (4) 1/2 HELICAL SPRING LOCKWASHERS,
FOUR (4) 1/2-13 HEAVY HEX NUTS (FR6TB12 ONLY),
FOUR (4) M12x1.75 HEX NUTS (FR6TB12M ONLY).
- FINISH COLOR: BLACK (EXCEPT FOR HARDWARE).
- DIMENSIONS IN PARENTHESES ARE IN METRIC.

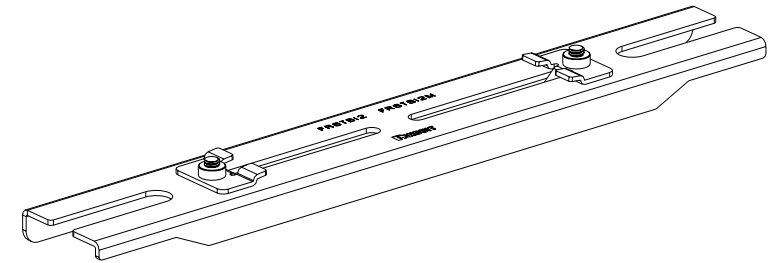
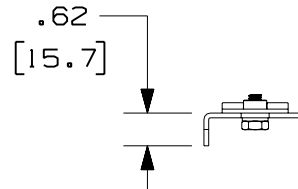
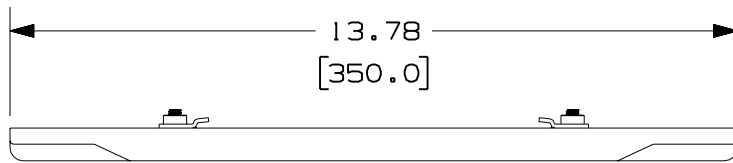
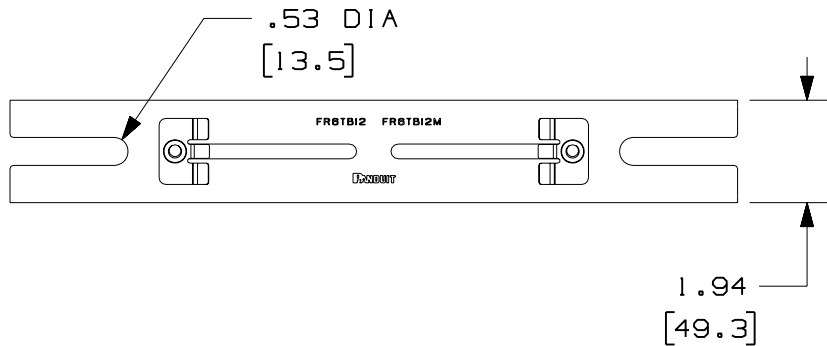

ENG. REF.: D38022CN_DC_FR6TB12_02.prt

CAD FILENAME/LAYERS: FR6TB12.pdf

-	-----	---	---	1. REVISED GENERAL NOTES	-----	--	--	
2	7-31-06	DTP	RN	H. REVISED PART WEIGHT G. REVISED DRAWING TITLE	38022-48	RN	RN	
-	-----	---	---	F. REMOVED ALL REFERENCES TO PART NUMBER FR6TB38.	-----	--	--	
-	-----	---	---	E. REVISED ENTIRE DRAWING TO INCLUDE P/N FR6TB12M.	-----	--	--	
-	-----	---	---	D. REVISED GENERAL NOTES. C. REVISED CHART.	-----	--	--	
1	12-22-04	MSO	RPA	B. REVISED DRAWING TITLE. A. REVISED CAD FILENAME.	38022-48	RN	RN	
R	10-2-01	JHNU	RPA	RELEASED TO PRODUCTION	38022-48	HIW	HIW	
REV	DATE	BY	CHK	DESCRIPTION	ECN	R	CUST	SUP GMBH

PANDUIT CORP TINLEY PARK, ILLINOIS

FIBERRUNNER 4x4 AND 6x4 QUIKLOCK TRAPEZE BRACKET - 1/2" (M12) THREADED ROD (FR6TB12, FR6TB12M)
CUSTOMER DRAWING

UNLESS OTHERWISE SPECIFIED, DIMENSIONAL TOLERANCES ARE:
(.X) ± (.XXX) ±
(.XX) ± .03 (.8) ANGLES ±

UNLESS OTHERWISE SPECIFIED, ALL DIMENSIONS ARE GIVEN IN INCHES, THIRD ANGLE PROJECTION.

SCALE: NONE

DRAWING NO. 38022-48 DWG SIZE A

DRAWN BY: JHNU MAT'L: STEEL

DATE: 10-2-01

CHK'D: RPA