

THIS COPY IS PROVIDED ON A RESTRICTED BASIS AND IS NOT TO BE USED IN ANY WAY DETRIMENTAL TO THE INTERESTS OF PANDUIT CORP.



PANDUIT PART NUMBER	WEIGHT
FR6TB38 FR6TB38M	1.10 LB/EACH (501g/EACH)



NOTES:

- SEE CURRENT CATALOG FOR ADDITIONAL PART SUFFIXES TO INDICATE PACKAGE QUANTITY.
- THE FIBERRUNNER 4x4 AND 6x4 QUIKLOCK TRAPEZE BRACKET IS USED TO SUPPORT THE FIBERRUNNER 4x4 AND/OR 6x4 CABLE ROUTING SYSTEMS BETWEEN TWO (2) SECTIONS OF NEW OR EXISTING 3/8" (M10) THREADED ROD THAT ARE 10" (254) - 13" (330.2) APART.
- THE FIBERRUNNER 4x4 AND 6x4 QUIKLOCK TRAPEZE BRACKET INCLUDES:
ONE (1) BRACKET ASSEMBLY,
FOUR (4) 3/8 HELICAL SPRING LOCKWASHERS (FR6TB38 ONLY),
FOUR (4) 3/8-16 HEAVY HEX NUTS (FR6TB38 ONLY),
FOUR (4) M10 HELICAL SPRING LOCKWASHERS (FR6TB38M ONLY),
FOUR (4) M10x1.5 HEX NUTS (FR6TB38M ONLY).
- FINISH COLOR: BLACK (EXCEPT FOR HARDWARE).
- DIMENSIONS IN PARENTHESES ARE IN METRIC.

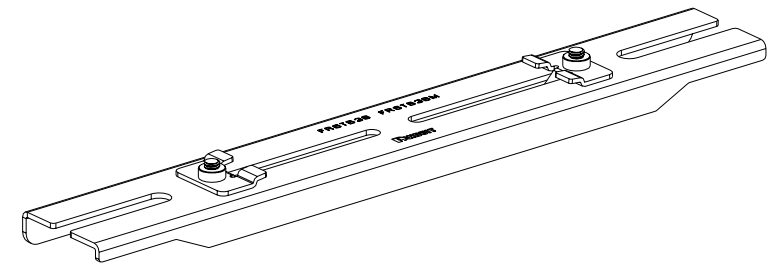
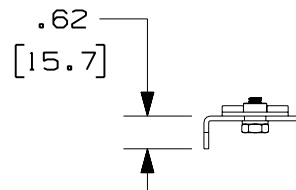
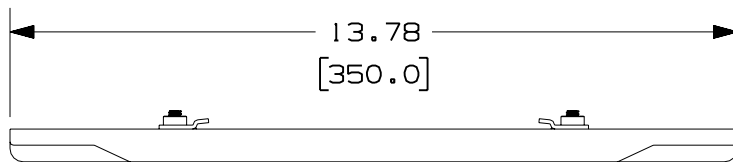
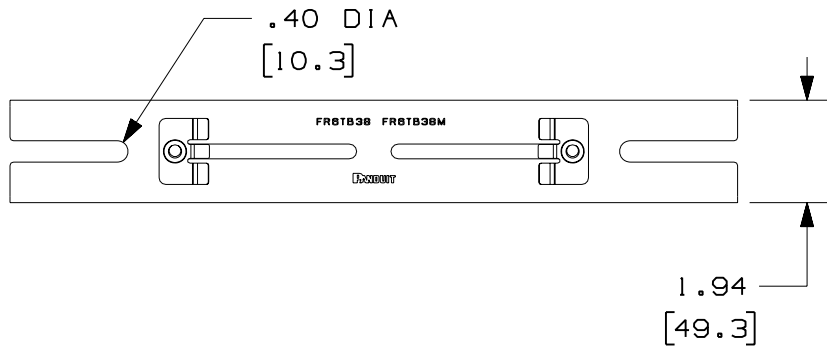

ENG. REF.: D38022CM_DC_FR6TB38_02.prt

CAD FILENAME/LAYERS FR6TB38.pdf

-	-----	---	---	1. REVISED GENERAL NOTES.	-----	--	--	
2	7-31-06	DTP	RN	H. REVISED PART WEIGHT. G. REVISED DRAWING TITLE.	38022-47	RN	RN	
-	-----	---	---	F. REMOVED ALL REFERENCES TO PART NUMBER FR6TB12M.	-----	--	--	
-	-----	---	---	E. REVISED ENTIRE DRAWING TO INCLUDE P/N FR6TB38.	-----	--	--	
-	-----	---	---	D. REVISED GENERAL NOTES. C. REVISED CHART.	-----	--	--	
1	12-22-04	MSO	RPA	B. REVISED DRAWING TITLE. A. REVISED CAD FILENAME.	38022-47	RN	RN	
R	10-2-01	JHNU	RPA	RELEASED TO PRODUCTION	38022-47	HIW	HIW	
REV	DATE	BY	CHK	DESCRIPTION	ECN	R	CUST	SUP GMBH

				<p>PANDUIT CORP TINLEY PARK, ILLINOIS</p> <p>FIBERRUNNER 4x4 AND 6x4 QUIKLOCK TRAPEZE BRACKET - 3/8" (M10) THREADED ROD (FR6TB38, FR6TB38M)</p> <p>CUSTOMER DRAWING</p>	
				<p>UNLESS OTHERWISE SPECIFIED, DIMENSIONAL TOLERANCES ARE: (.X) ± (.XXX) ± (.XX) ± .03 (.8) ANGLES ±</p>	
<p>DRAWN BY: JHNU</p> <p>DATE: 10-2-01</p> <p>CHK'D: RPA</p>		<p>MAT'L: STEEL</p>		<p>SCALE: NONE</p> <p>DRAWING NO.: 38022-47</p> <p>DWG SIZE: A</p>	