

Technical Information

PanelMax™ Noise Shield

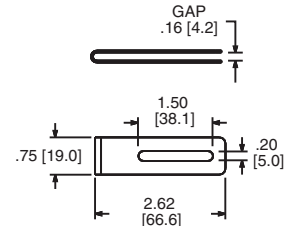
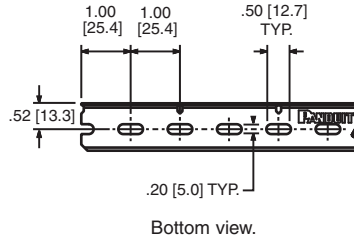
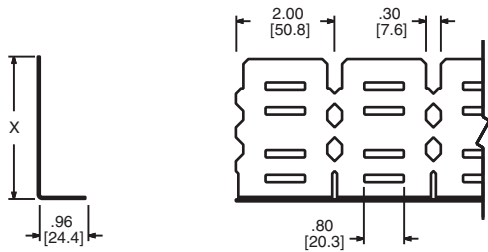

Part No.	X — Inches (mm)
SD2EMI	1.82 (46.1)
SD3EMI	2.88 (73.2)
SD4EMI	3.86 (98.2)

Sidewall: SD3EMI shown. SD2EMI sidewall features one pair of cable tie slots per section.

Bonding clip (for use with wiring duct).

PanelMax™ Shielded Wiring Duct

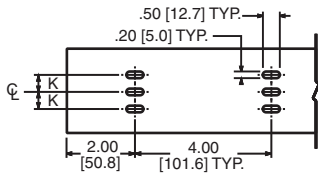
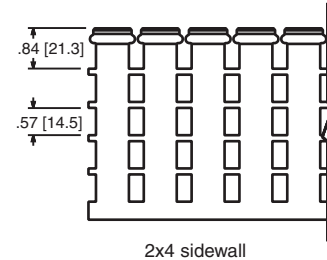
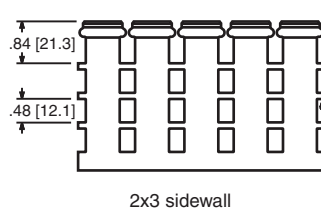
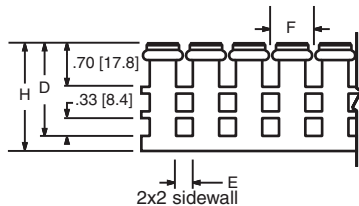
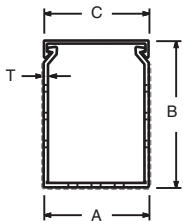

Part Number	Dimensions — Inches (mm)									
	A	B	C	D	E	F	H	K	T	
G2X2LG6EMI	2.25 (57.2)	2.12 (53.8)	2.25 (57.2)	1.61 (41.0)	0.31 (7.9)	0.80 (20.3)	2.00 (50.8)	0.50 (12.7)	0.08 (2.0)	
G2X3LG6EMI	2.25 (57.2)	3.12 (79.2)	2.25 (57.2)	2.64 (67.0)	0.31 (7.9)	1.00 (25.4)	3.00 (76.2)	0.50 (12.7)	0.10 (2.4)	
G2X4LG6EMI	2.25 (57.2)	4.10 (104.1)	2.25 (57.2)	3.62 (91.9)	0.31 (7.9)	1.00 (25.4)	4.00 (101.6)	0.50 (12.7)	0.11 (2.7)	

PanelMax™ Shielded Wiring Duct Wire Fill

Part Number	Nominal Area in ²	Electrical														Communication				
		8 AWG		10 AWG		12 AWG		14 AWG		16 AWG		18 AWG		22 AWG	23 AWG	23/24 AWG	24 AWG	Fiber Cable		
		0.216	0.164	0.130	0.141	0.152	0.111	0.124	0.133	0.096	0.111	0.118	0.084	0.100	0.106	0.085	0.330	0.250	0.190	0.118
		THHN	THHN	THHN	MTW	MTW	THHN	MTW	MTW	TFFN	MTW	MTW	TFFN	MTW	MTW	MTW	Cat 6A	Cat 6	Cat 5e	3.0 mm
G2X2LG6EMI	4.000	48	84	135	114	98	185	148	129	248	185	164	323	228	203	316	20	36	63	163
G2X3LG6EMI	6.000	73	127	202	172	148	278	222	193	372	278	246	485	342	305	474	31	54	94	245
G2X4LG6EMI	8.000	97	169	270	229	197	371	297	258	496	371	328	647	457	406	632	41	73	126	327

Table shows maximum wire fill based on 50% of duct internal cross sectional area. Formula = Nominal Area / 1.75xD². All dimensions represent typical outer cable diameter in inches.

Related products



NR1 Nylon Rivet
For use with TNR tool



TNR Nylon Rivet Installation Tool
Hand-held tool for easy rivet installation



DNT-100 Notching Tool
Notches duct sidewalls to bottom scoreline for tees and corners



DCT Tool
Provides a smooth burr-free cut on both wiring duct and cover



CWST Tool
Snipping tool cuts conductors flush for improved performance

WORLDWIDE SUBSIDIARIES AND SALES OFFICES

PANDUIT CANADA
Markham, Ontario
cs-cdn@panduit.com
Phone: 800.777.3300

PANDUIT EUROPE LTD.
London, UK
cs-emea@panduit.com
Phone: 44.20.8601.7200

PANDUIT SINGAPORE PTE. LTD.
Republic of Singapore
cs-ap@panduit.com
Phone: 65.6305.7575

PANDUIT JAPAN
Tokyo, Japan
cs-japan@panduit.com
Phone: 81.3.6863.6000

PANDUIT LATIN AMERICA
Guadalajara, Mexico
cs-la@panduit.com
Phone: 52.33.3777.6000

PANDUIT AUSTRALIA PTY. LTD.
Victoria, Australia
cs-aus@panduit.com
Phone: 61.3.9794.9020

For a copy of Panduit product warranties, log on to www.panduit.com/warranty



For more information
Visit us at www.panduit.com
Contact Customer Service by email: cs@panduit.com
or by phone: 800.777.3300 and reference WDCB26

©2012 Panduit Corp.
ALL RIGHTS RESERVED.
Product Bulletin Number **WDCB26--SA-ENG**
replaces SA-WDCB23
7/2012