

## Surge Suppressor User Manual

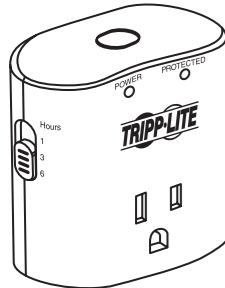

# SK10TG

# TRIPP-LITE

[www.tripplite.com/support](http://www.tripplite.com/support)

## Features

- A** On / Off Button
- B** Time Selector
- C** LED Surge Protection Indicator
- D** LED Power Light
- E** Device Outlet

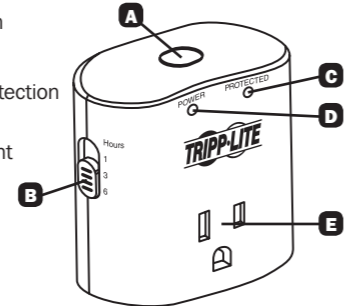

## Quick Setup Guide

- 1** Plug Surge Suppressor into any standard 3-pin power outlet. It's best to plug Surge Suppressor into the top socket of a power outlet so as not to obstruct use of the second outlet.

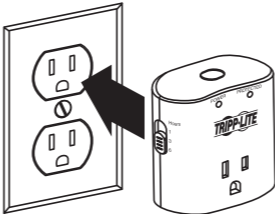

## Quick Setup Guide

- 2** Plug a household device into the Surge Suppressor.

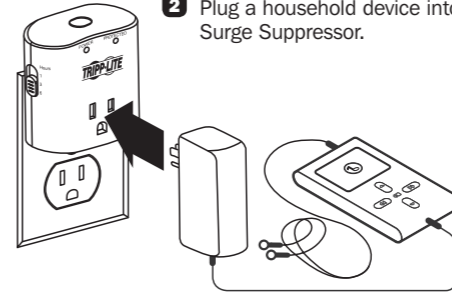

## Quick Setup Guide

- 3** Select your desired countdown time using the switch located on the left side of your Surge Suppressor.  
Recommended countdown settings for the following devices:
  - **1 HOUR:** Hot Coil Items – hair straighteners, clothes irons, soldering irons, toaster ovens, coffee makers, fans.
  - **3 HOURS:** Mobile Electronics – chargers, mobile phones, MP3 players, cameras.
  - **6 HOURS:** Chargers for Large Cordless Devices – handheld vacuum cleaners, cordless drills.

## Quick Setup Guide

**NOTE:** You can change your countdown time setting at any time during operation.

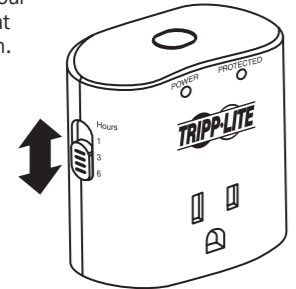

## Quick Setup Guide

**4** Push the start button on the top of your Surge Suppressor.

Once you've done this, the LED will illuminate red and power will flow to your attached device.

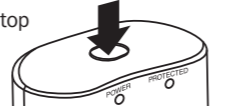

**NOTE:** The On / Off button can turn off the unit any time during operation.

**5** Once the countdown timer reaches zero, your Surge Suppressor will power down and the LED will turn off. **NOTE:** When sitting idle the Surge Suppressor uses no power.

## Product Features

- Timer selection switch (1, 3 or 6 hours): Helps make connected devices more energy efficient
- On / Off push button
- Red LED indicator lights when Surge Suppressor is active
- Standard 3-pin power outlet compliant
- Does not obstruct the lower outlet of a standard 3-pin power outlet when plugged into the top outlet
- Low power consumption operation saves energy
- 350-joule surge protection

## Troubleshooting

**When using the Surge Suppressor, my device does not fully charge.**

Make sure you have selected an appropriate time period for the device you are trying to charge by referring to step 3 of the Quick Setup Guide, or simply increase the time period selected on the Surge Suppressor.

## Specifications

- Continuous Duty Electrical Rating: 120V~/15A /60Hz/1800W
- Standby Power Consumption: 0.75W
- Surge Protection:
  - 1) Voltage Protective Rating: 400V
  - 2) Max. Surge Voltage: 6000V
  - 3) Max. Spike Current: 6500A
  - 4) Response Timer: <1 nanosecond

## Safety Information

- Important: Use indoors in a dry location.
- Contains no user-serviceable parts; do not open.